

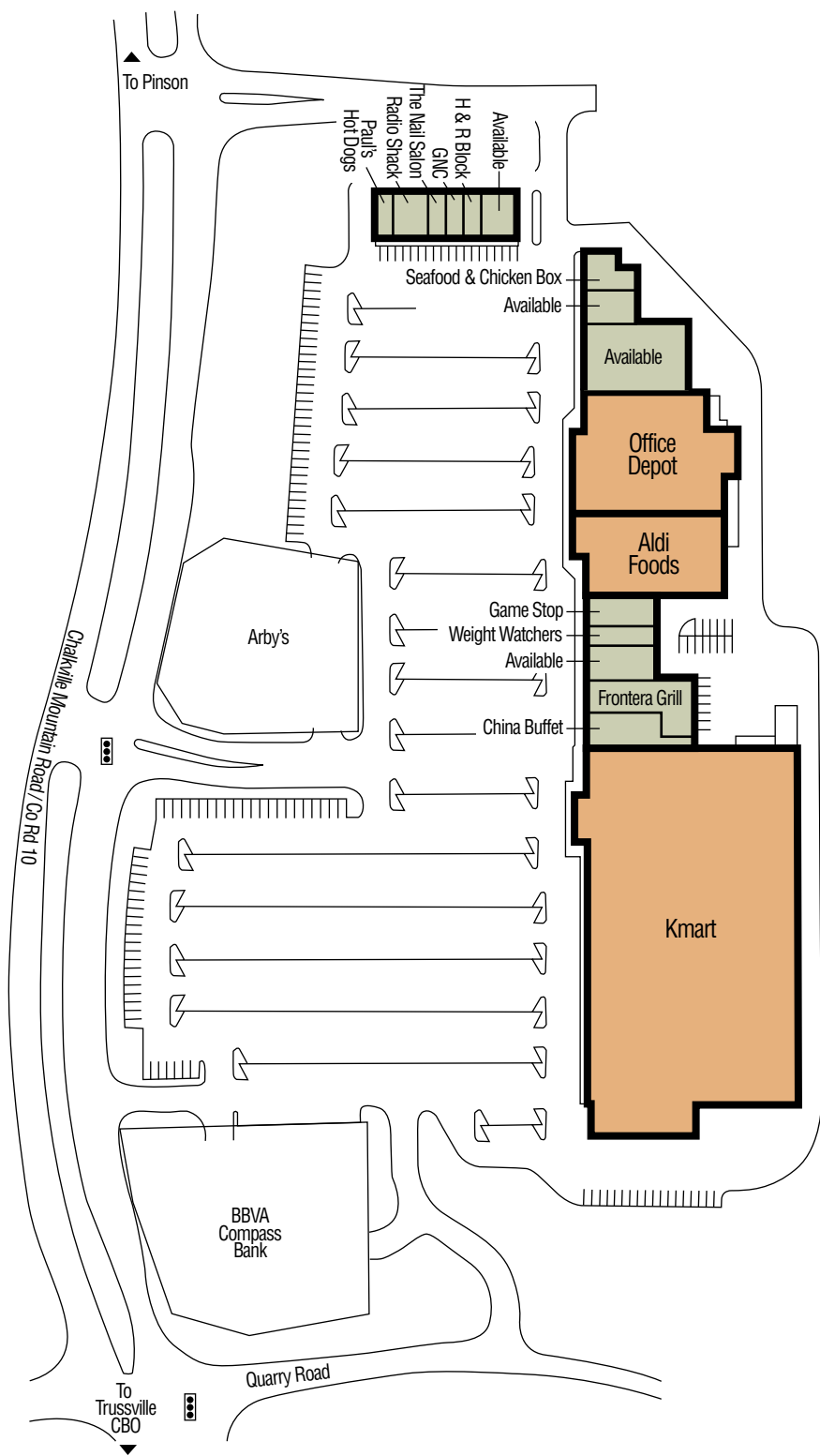

Trussville Shopping Center

Trussville, Alabama

ARONOV



The Project

Kmart, Aldi Foods,
Office Depot, Specialty Shops

Total Square Feet **165,641**

The Market

Total Trade
Area Population **364,945**

Average Household
Income **\$71,241**

3500 Eastern Boulevard
Montgomery, AL 36116
www.aronov.com
tel 334-277-1000
fax 334-272-0747

The Center

Trussville Shopping Center

Trussville, Alabama

Location

Chalkville Mountain Road,
Trussville, Alabama

For Leasing Information
Contact Allen Schmidt
334-277-1000 ext. 425
allen.schmidt@aronov.com

- Located on Chalkville Mountain Road (County Road 10), where traffic counts exceed 32,800 vehicles per day.
- Trussville Shopping Center is centrally located in the city's growth corridor and is in close proximity to Interstate 59 and the Trussville Central Business District.
- I-59 Interchange at Chalkville Mountain Road boasts a traffic count of more than 52,160 vehicles per day.
- Adjacent to a Wal-Mart SuperCenter, Sam's Warehouse, Kohl's and other popular retailers.
- Seafood & Chicken Box in Trussville Shopping Center was named "Where to Eat at the South's Best Fried Chicken Restaurants" by Southern Living Magazine.
- The center is the retail hub of northeast Birmingham which includes Irondale, Moody, Centerpoint, Clay and Huffman.

