

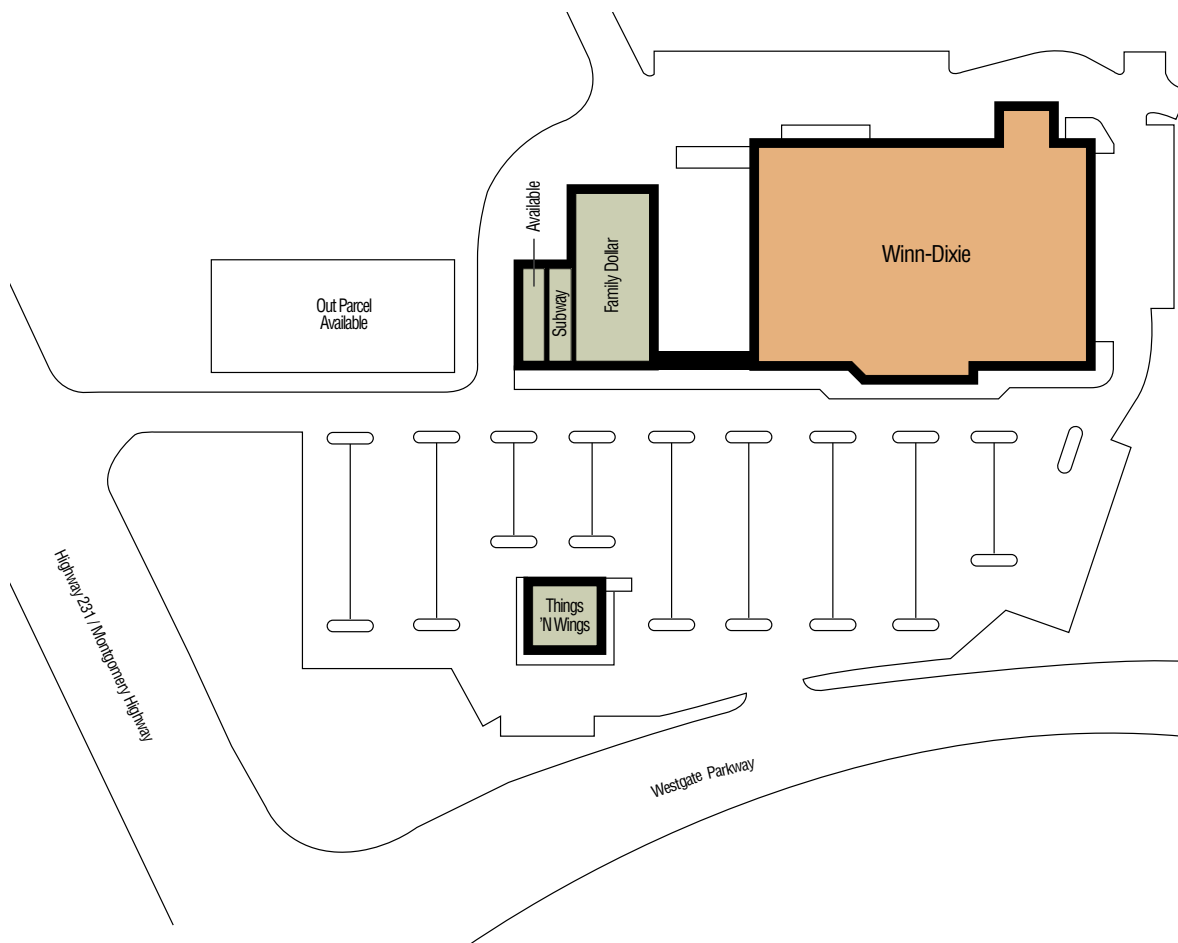

ARONOV

Wiregrass Plaza

Dothan, Alabama



The Project

Winn-Dixie, Specialty Shops

Total Square Feet **60,300**

The Market

7 MILES

Total Trade

Area Population **73,659**

Average Household

Income **\$60,088**

3500 Eastern Boulevard
Montgomery, AL 36116

www.aronov.com

tel 334-277-1000

fax 334-272-0747

The Center

Wiregrass Plaza

Dothan, Alabama

Location

Hwy 231 / Montgomery Hwy
& Westgate Parkway,
Dothan, Alabama

Traffic Count

Hwy 231 /
Montgomery Hwy **34,960**

For Leasing Information
Contact Leslie Zeanah
334-277-1000 ext. 539
leslie.zeanah@aronov.com

- Wiregrass Plaza is located just off Highway 231, the major traffic artery leading into the city from the north and south. The center is located on Westgate Parkway which is a highly traveled highway connecting well-established high-density residential areas with Highway 231N.
- Good traffic ingress/egress.
- Less than ¼ mile from Wiregrass Commons Mall, the only regional enclosed mall in the market. Anchors include Belk, Burlington Coat Factory, Dillard's and JCPenney.
- New residential developments are underway within a mile of the center.
- Wallace Community College (enrollment 5,624), two year associate degree institution and Troy University Dothan (enrollment 2,200), a four year university that offers undergraduate and graduate degrees, both are located less than five miles from the center.
- The renowned Robert Trent Jones Golf course neighborhood features homes valued between \$500,000 and \$1 million and is located three miles from the center.

